

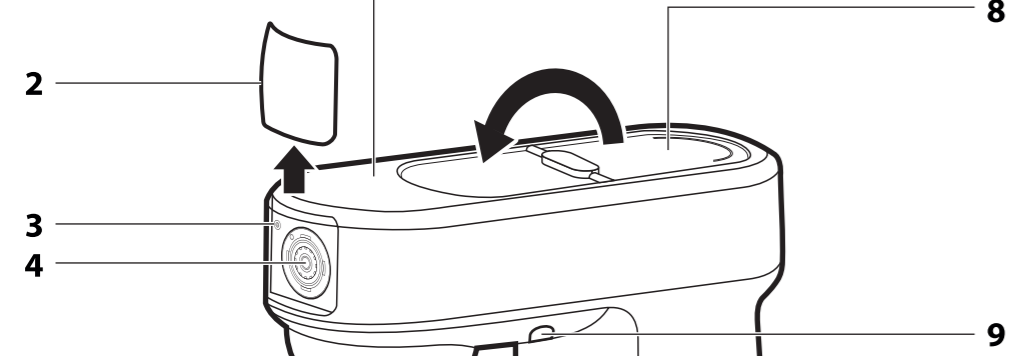

Food Processor EN User's manual

BEFORE FIRST USE... Please read the user's manual thoroughly...



DESCRIPTION OF THE APPLIANCE AND ACCESSORIES... 1. The out-multipurpose head...

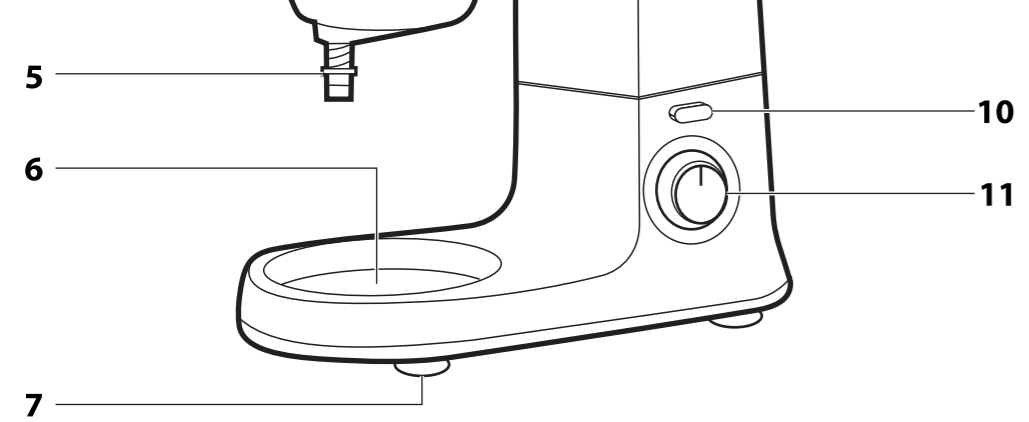

INTENDED USE OF THE APPLIANCE... The food processor is intended for preparing a standard amount of food...

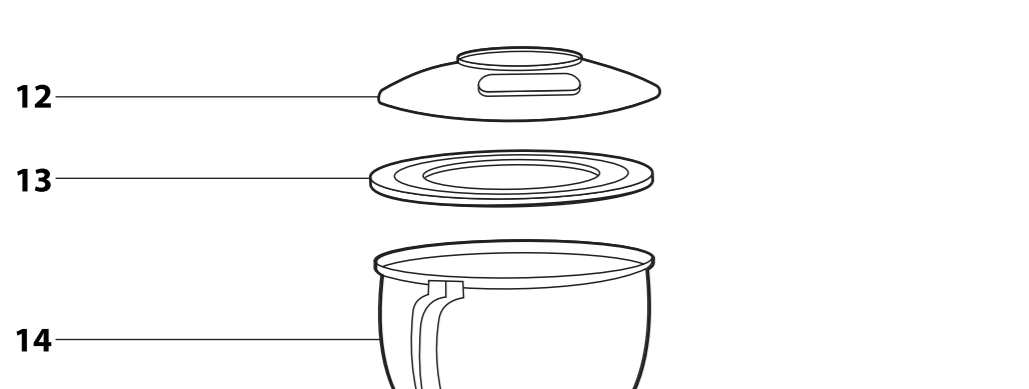

BEATING, WHIPPING AND KNEADING PLANETARY MIXER SYSTEM... The planetary mixing system is based on the principle of orbital rotation...

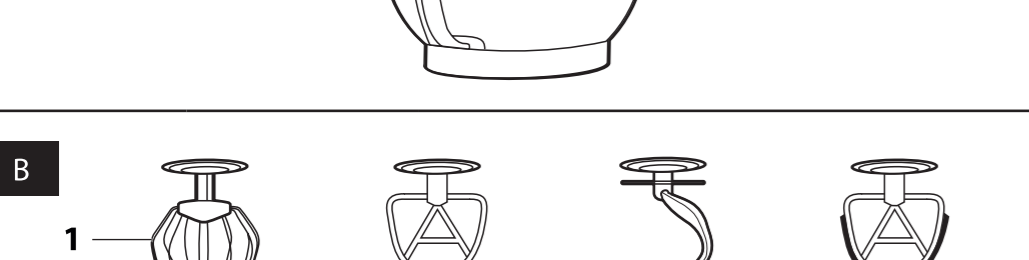

PREPARING FOR OPERATION... Warning: Before you start assembling or disassembling the accessories...

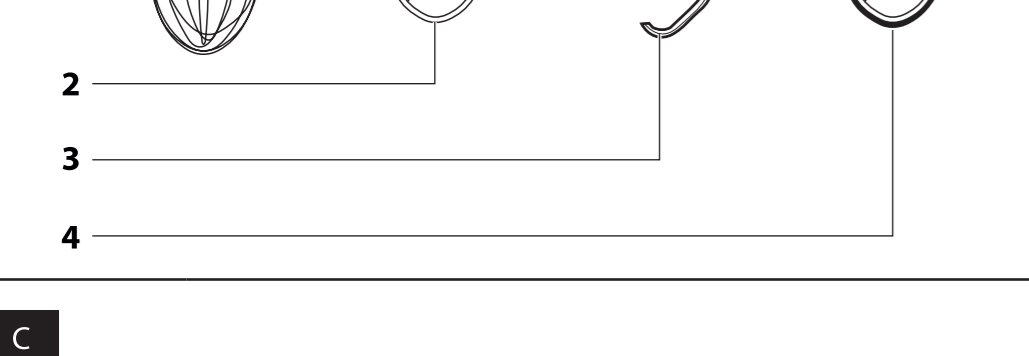

ENDING OPERATION AND DISASSEMBLING THE GRINDER... Remove the power cord from the power socket...

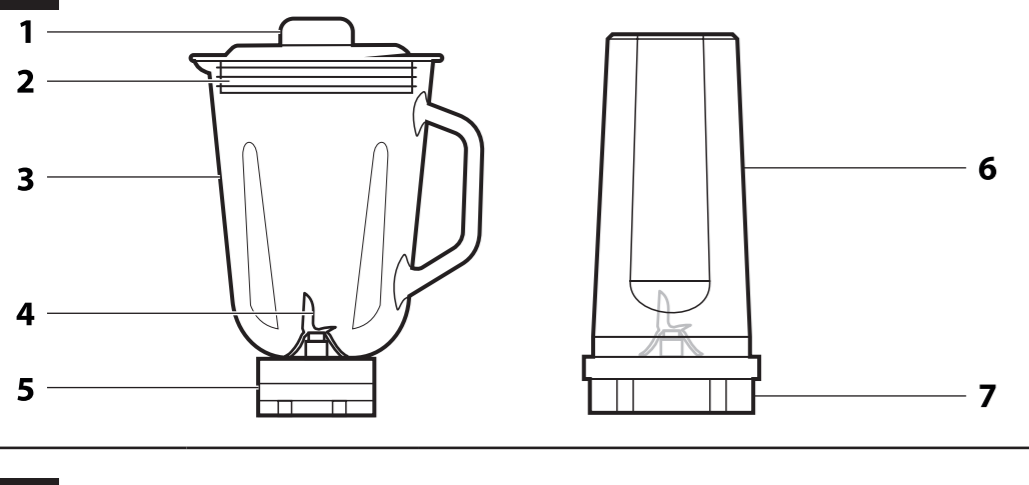

GRATING... The grater is needed for grating practically all types of fruit and vegetables...

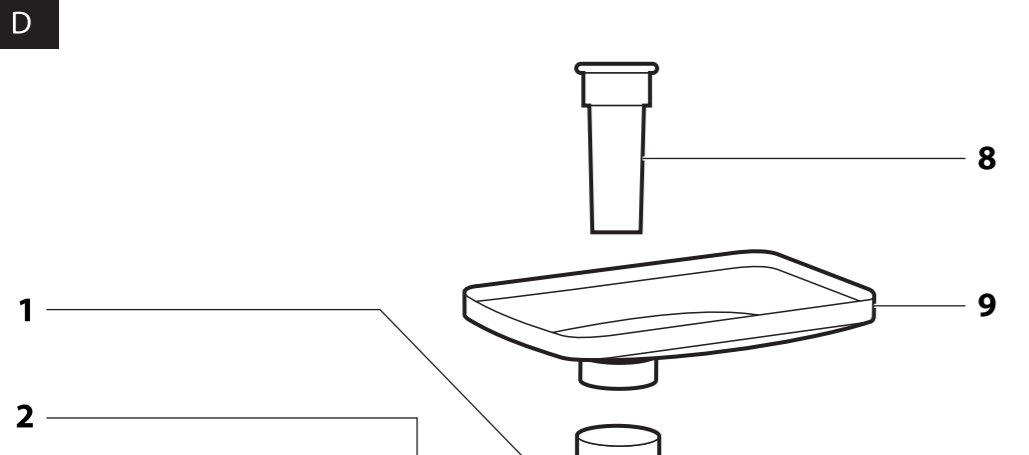

MARKING COSMETICS, PASTA OR STUFFING... Proceed in the same manner when assembling the grinder for marking...

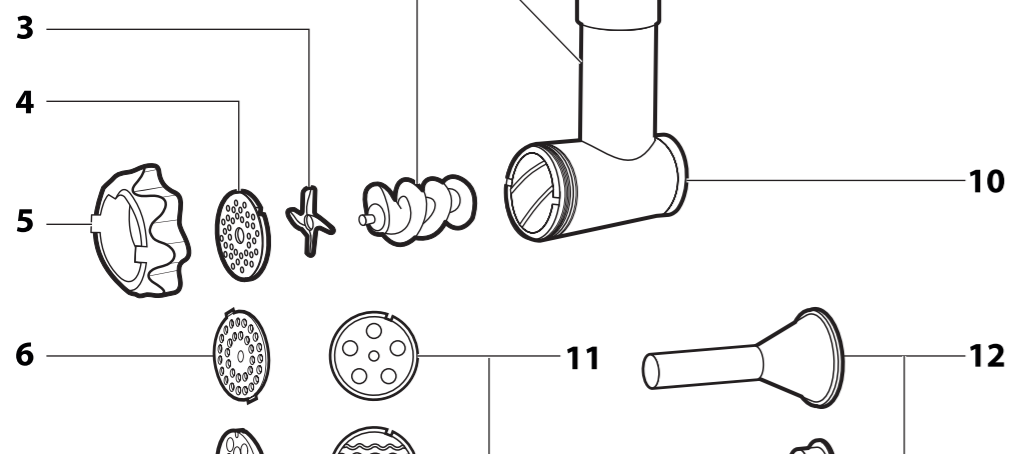

OPERATION... Connect the power cord to an AC power socket...

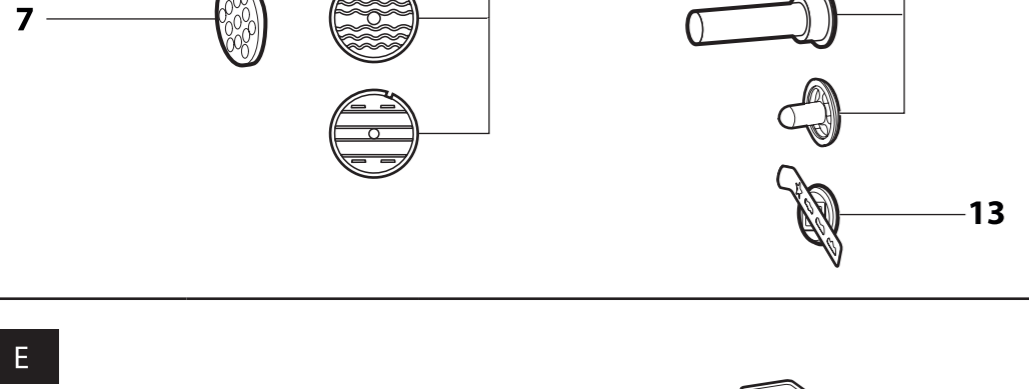

Releasing stuck ingredients... In the event that the food processor is disassembled...

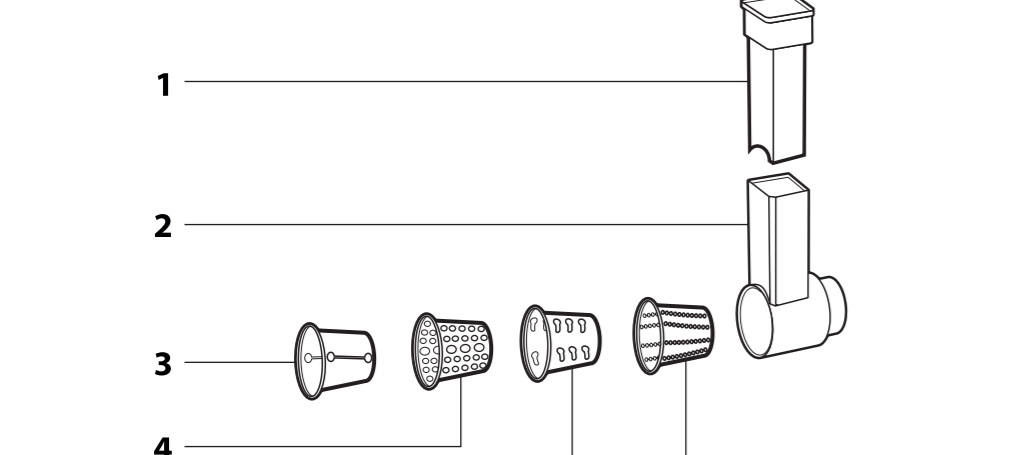

Operating time of the food processor... When blending, chopping or kneading, do not leave the appliance in continuous operation...

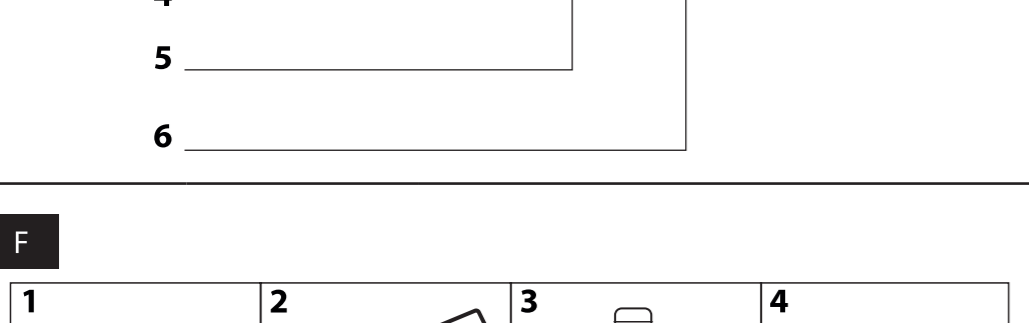

Quick guide to preparing ingredients... Attachment type, Ingredients, Speed, Processing time...

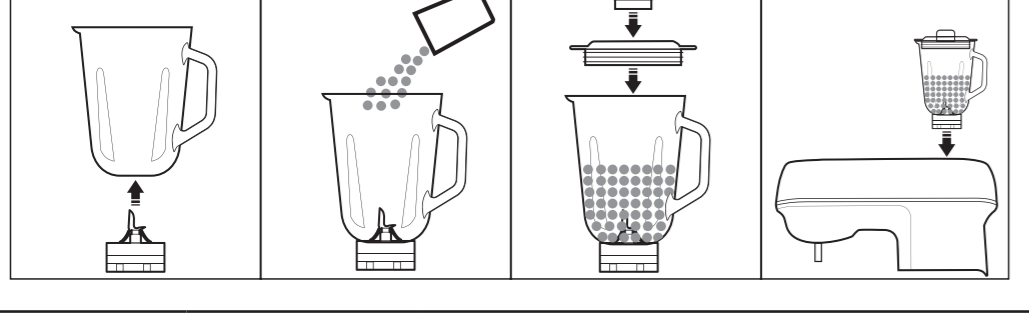

ASSEMBLING THE BLENDER... Prepare the food processor for blending...

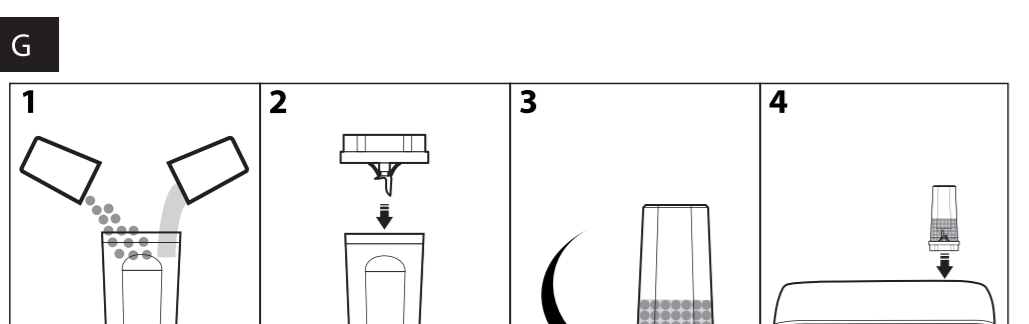

1.5 liter blending jar - assembling and mounting (Fig. 15)... Prior to using the blending jar to blend...

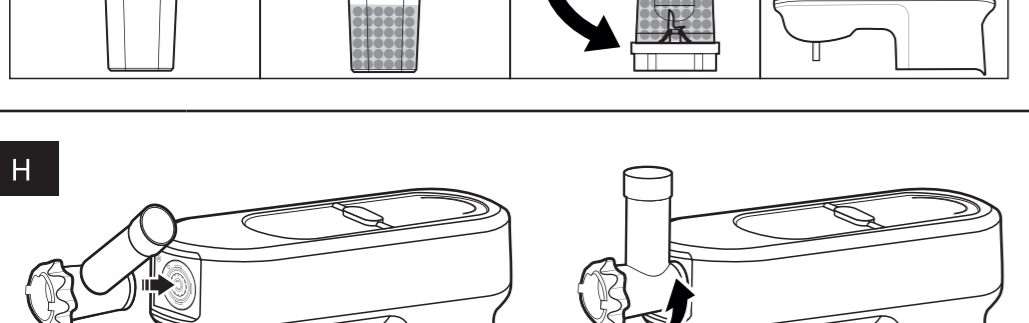

0.6 liter smoothie jar - assembling and mounting (Fig. 16)... Add the liquids and/or food that you wish to blend into the smoothie jar...



QUICK GUIDE TO PROCESSING INGREDIENTS... Ingredients, Speed selection, Recommended blending time...



Explanation of technical terminology... Electrical shock protection is provided by double or heavy-duty insulation...



DISPOSAL OF USED ELECTRICAL AND ELECTRONIC EQUIPMENT... Do not dispose of the appliance in your municipality...

Kuchynský robot CZ Návod k použití

BEFORE FIRST USE... Před použitím pečlivě přečtěte uživatelský manuál...

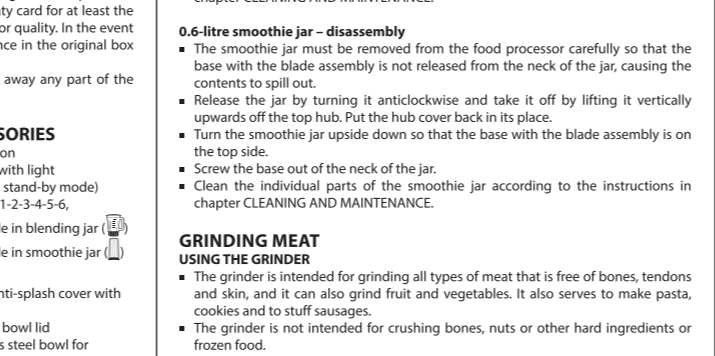

DESCRIPTION OF THE APPLIANCE AND ACCESSORIES... 1. Výstupní multifunkční hlava...

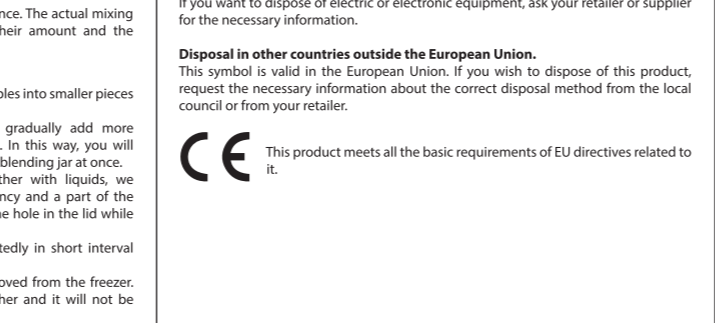
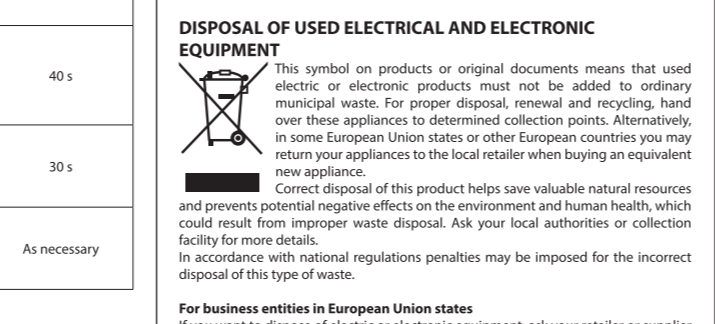
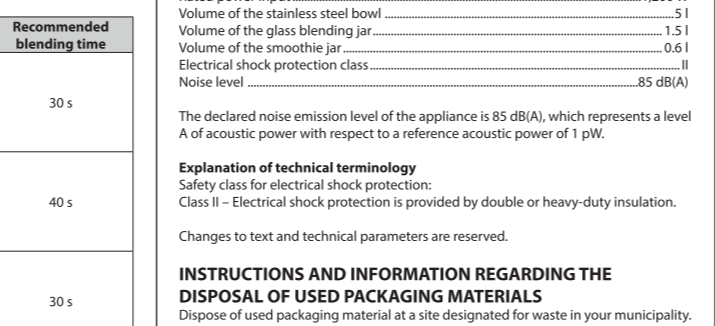
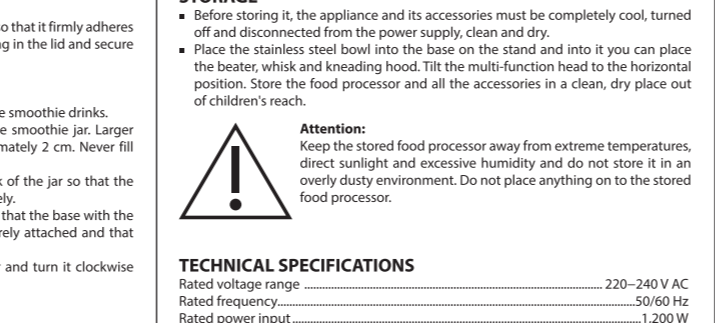
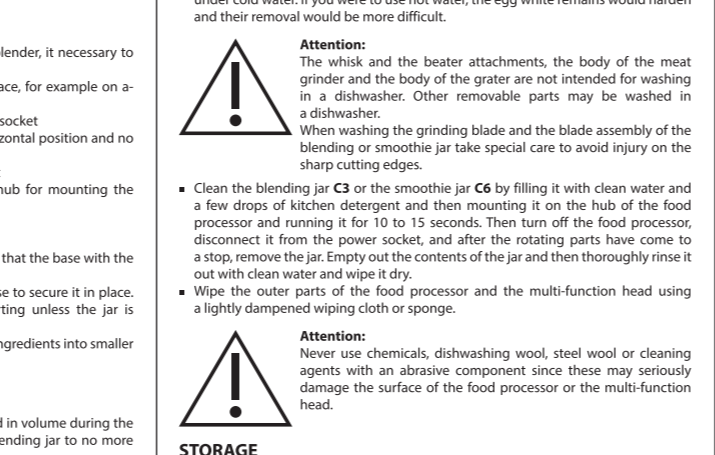
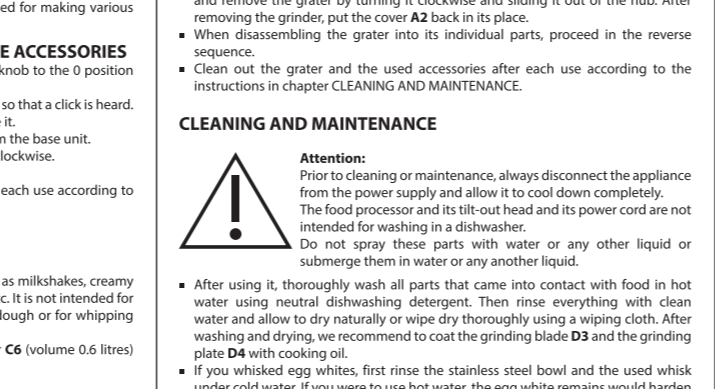
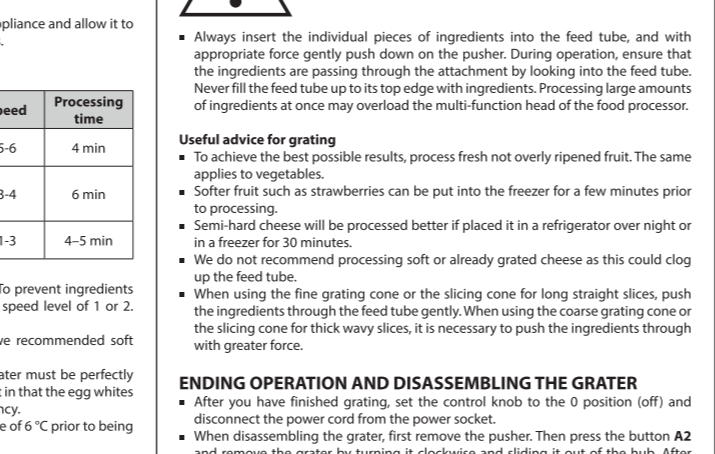
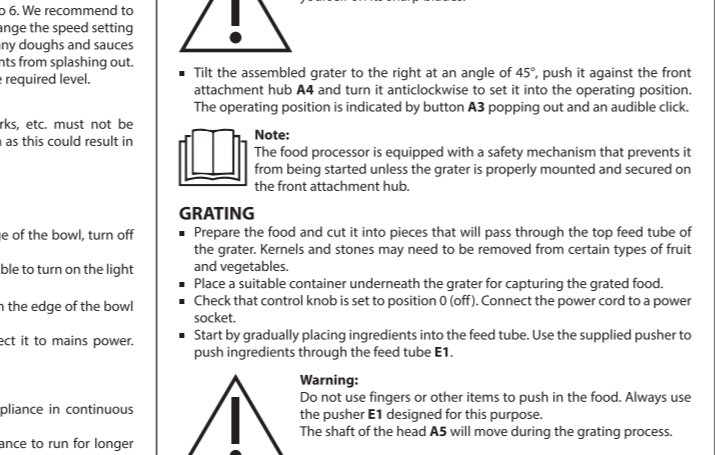
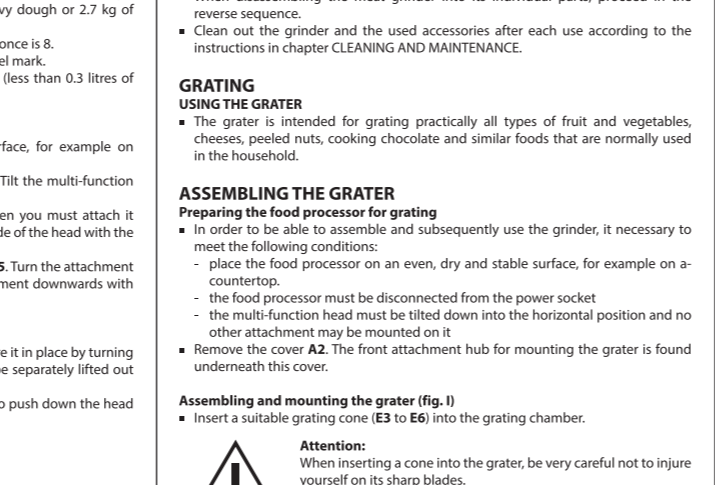
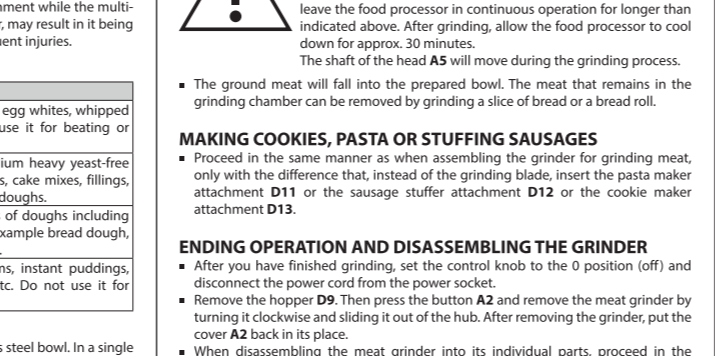
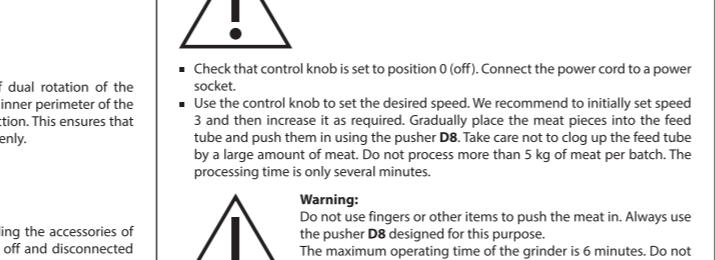
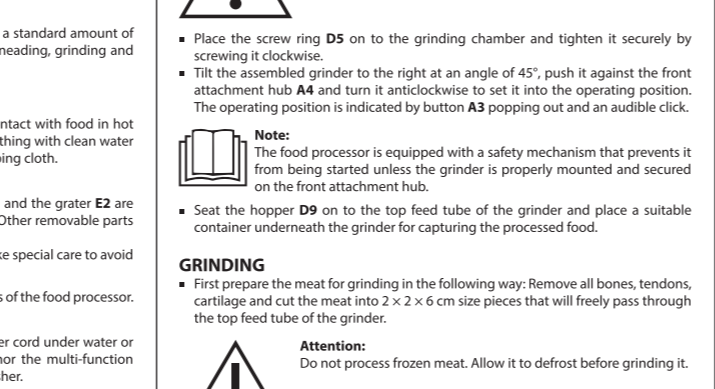
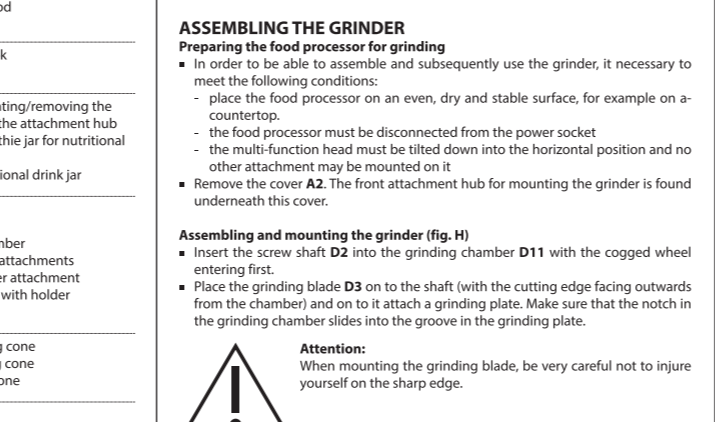

Kuchynský robot SK Návod na použitie

BEFORE FIRST USE... Pred použitím starostlivo prečítajte návody na použitie...

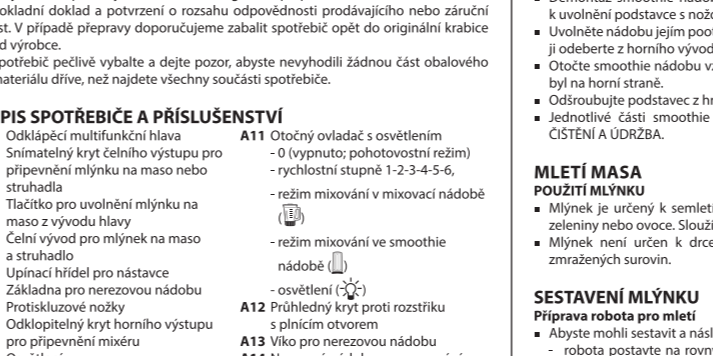

DESCRIPTION OF THE APPLIANCE AND ACCESSORIES... 1. Výstupná multifunkčná hlava...

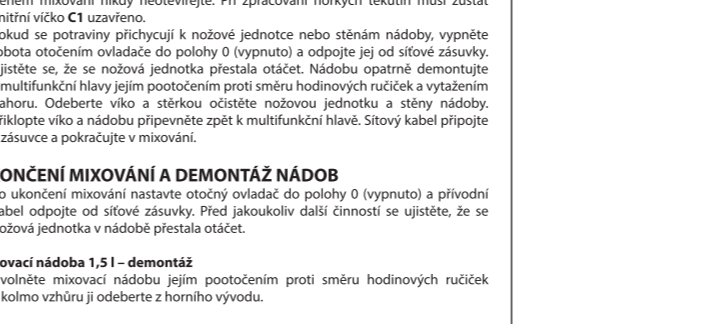
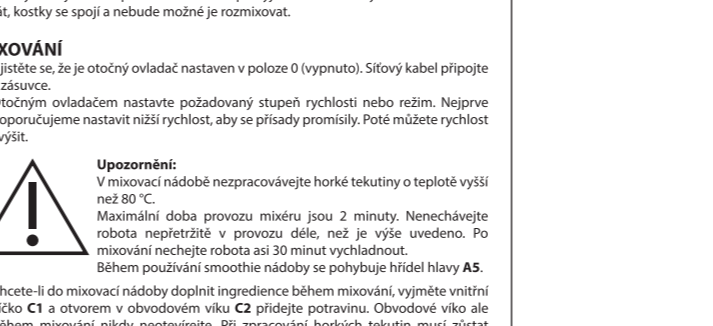
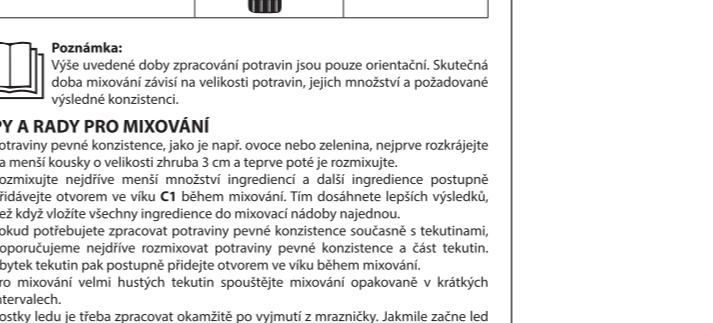
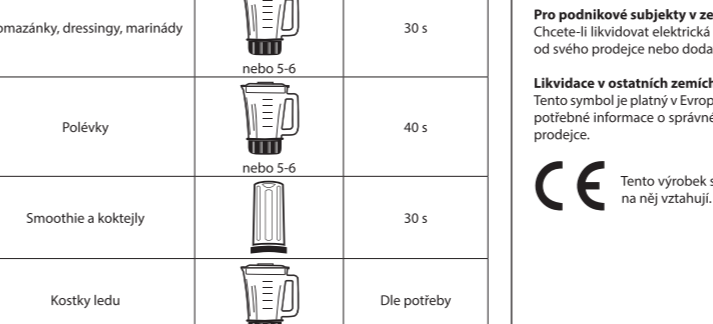
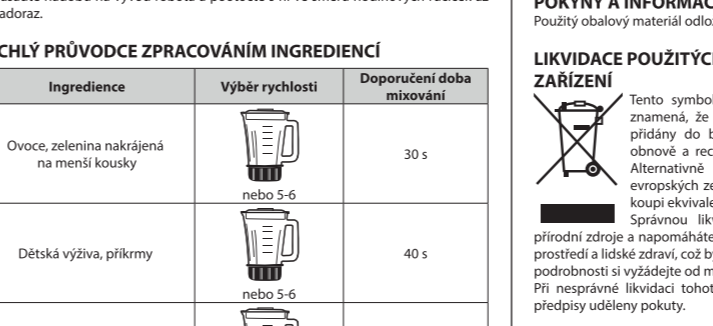
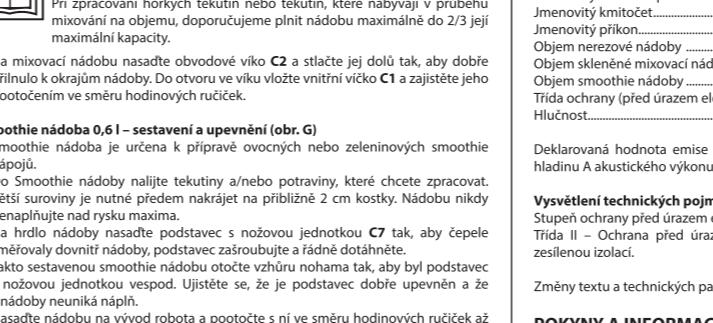
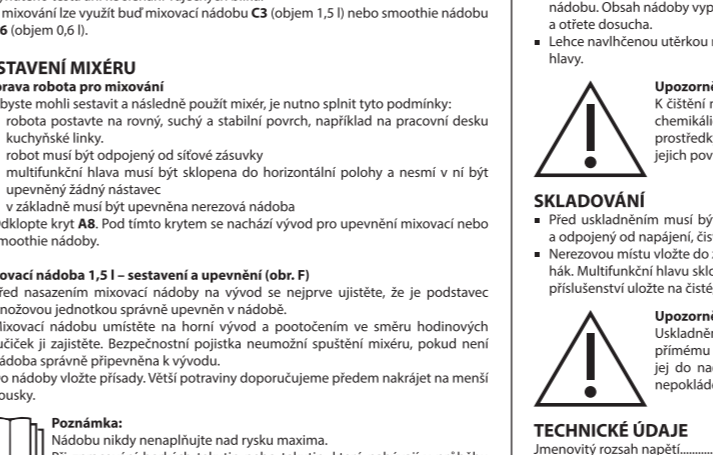
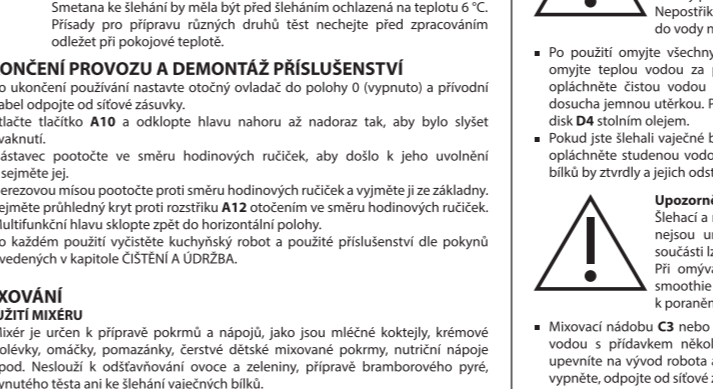
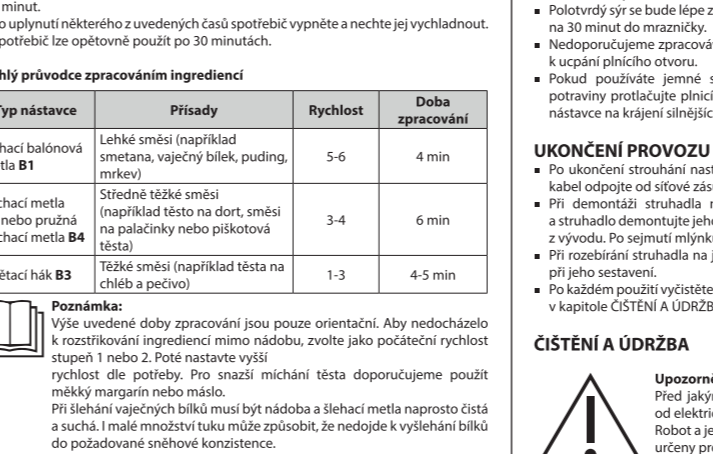
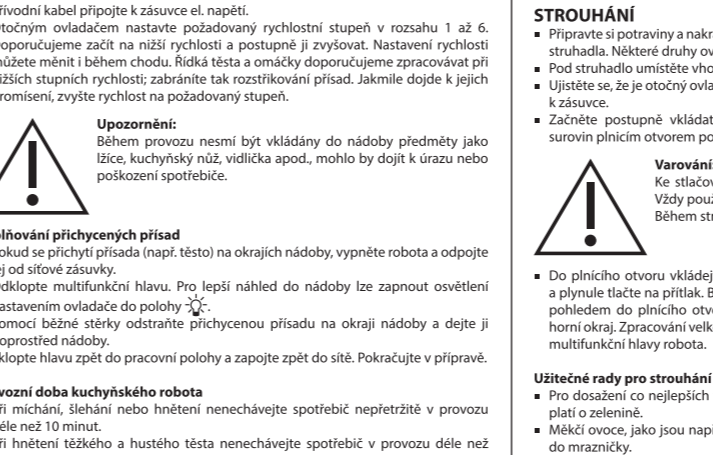
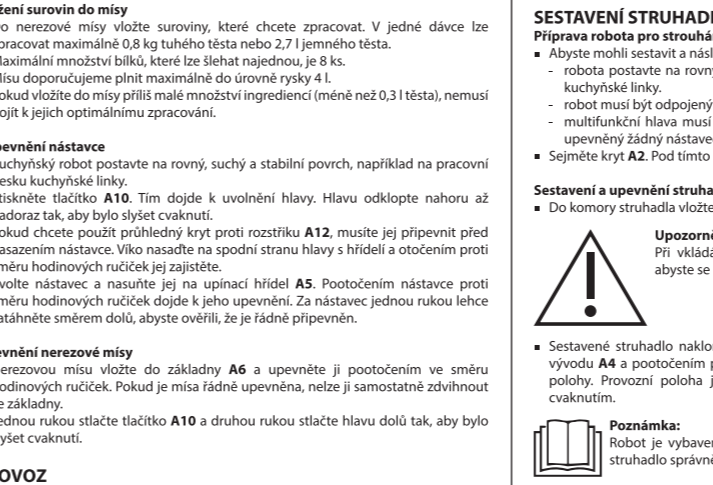
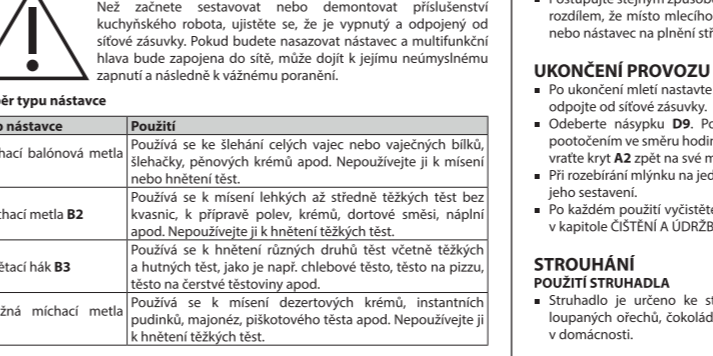
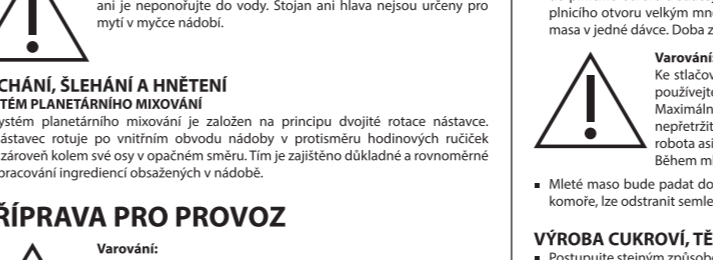
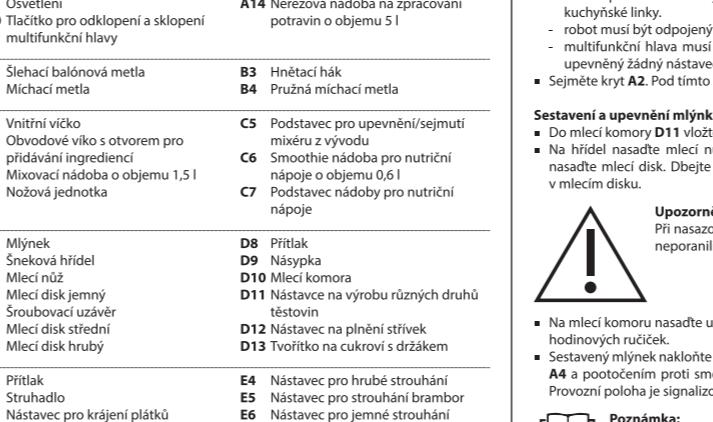

Kuchynský robot SK Návod na použitie

BEFORE FIRST USE... Pred použitím starostlivo prečítajte návody na použitie...

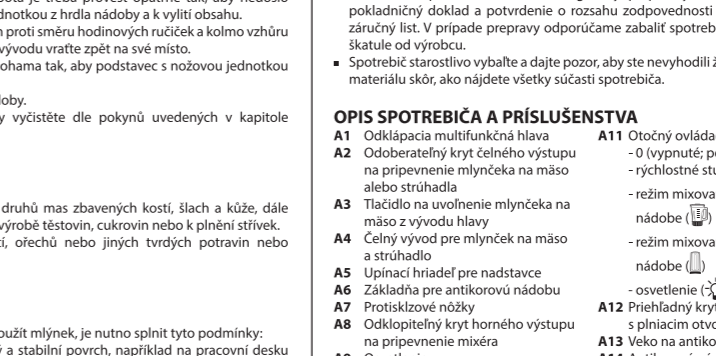

DESCRIPTION OF THE APPLIANCE AND ACCESSORIES... 1. Výstupná multifunkčná hlava...

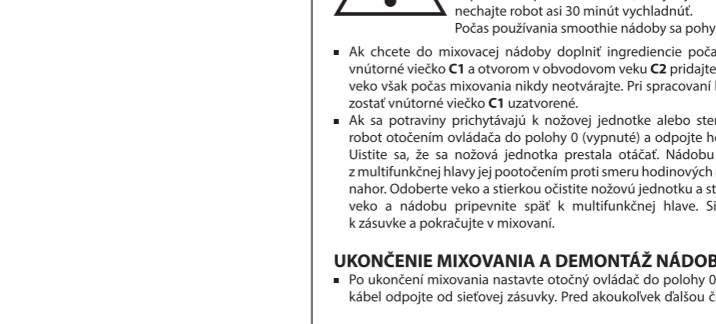
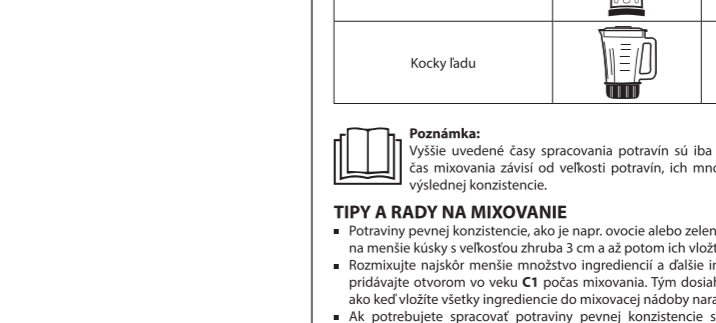
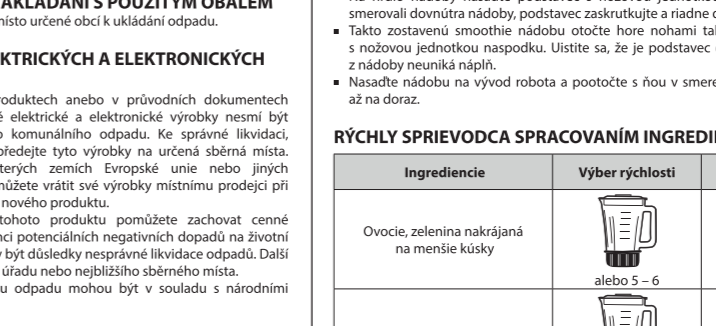
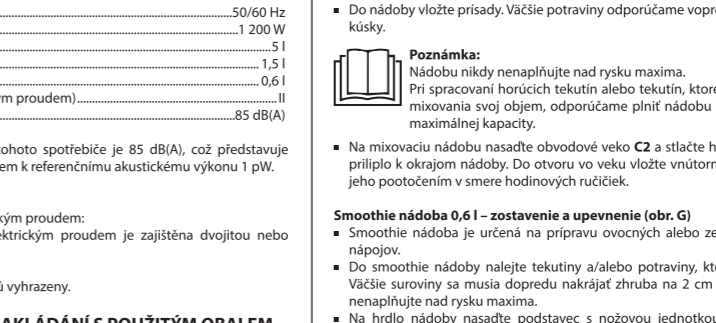
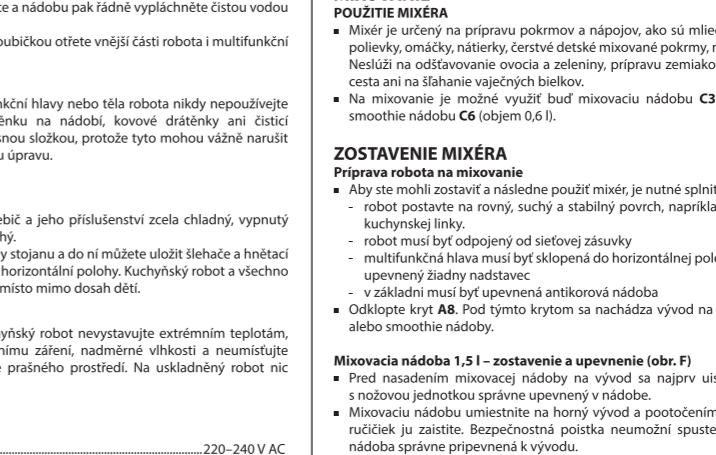
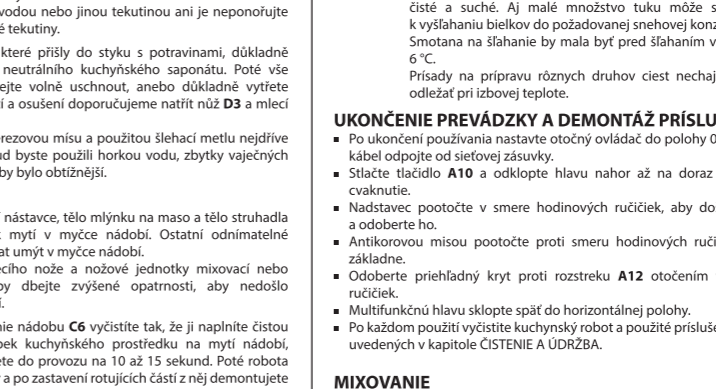
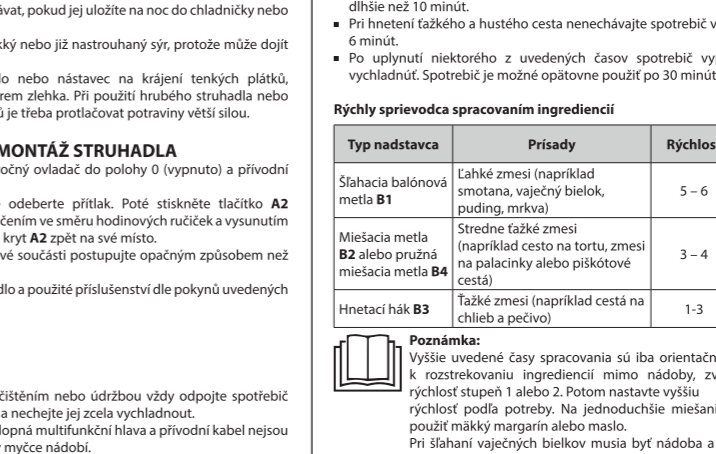
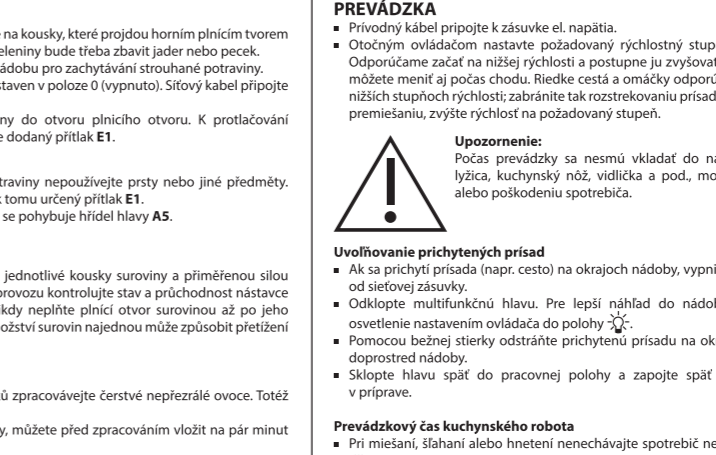
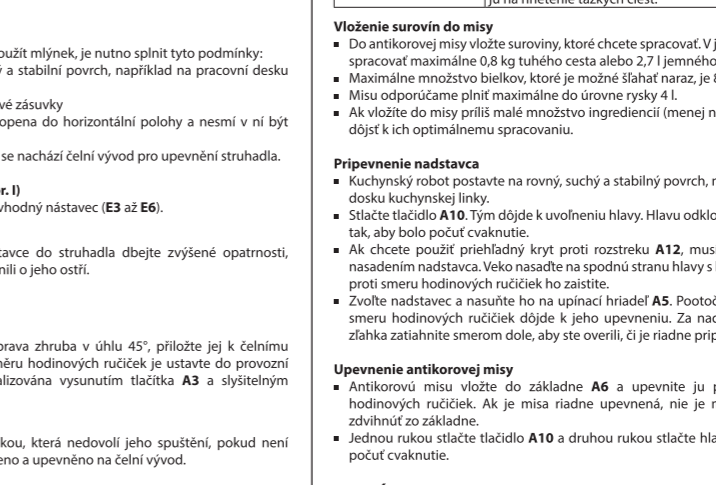
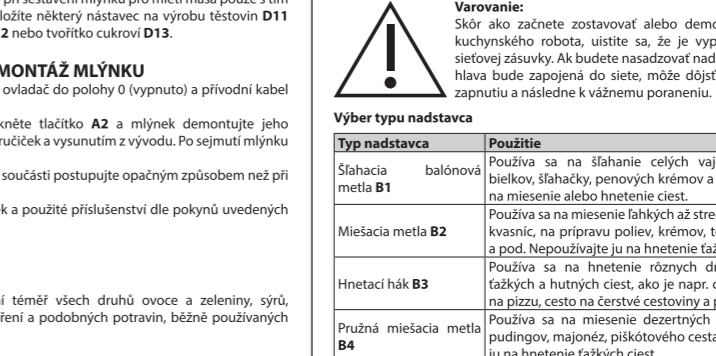
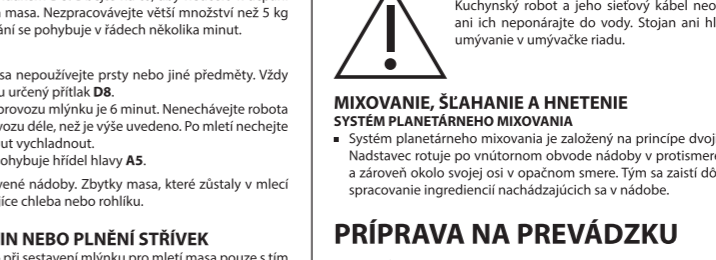
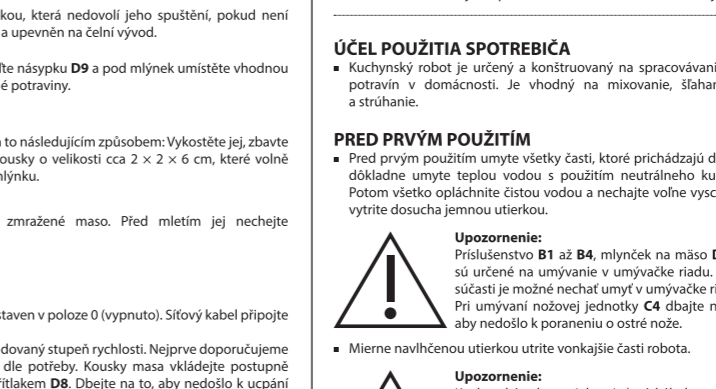
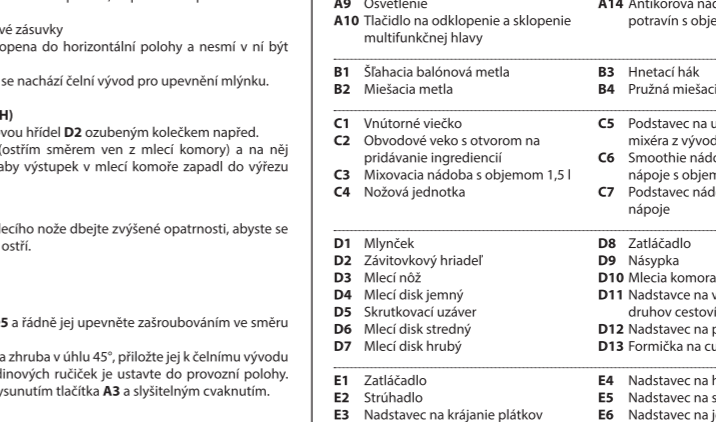

Kuchynský robot SK Návod na použitie

BEFORE FIRST USE... Pred použitím starostlivo prečítajte návody na použitie...

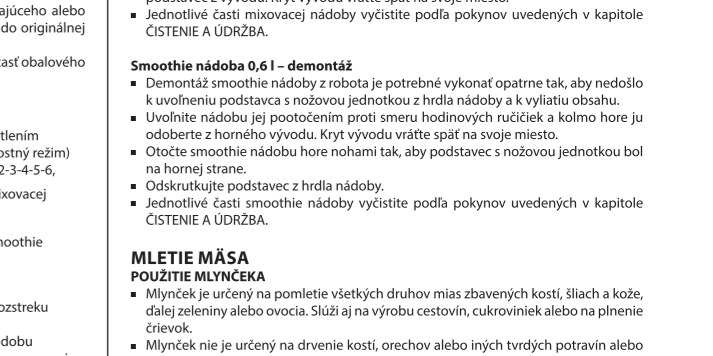

DESCRIPTION OF THE APPLIANCE AND ACCESSORIES... 1. Výstupná multifunkčná hlava...

